

# Micro HDAS

Miniature High-Density & Reliability  
1,27mm / .050" pitch PCB connector

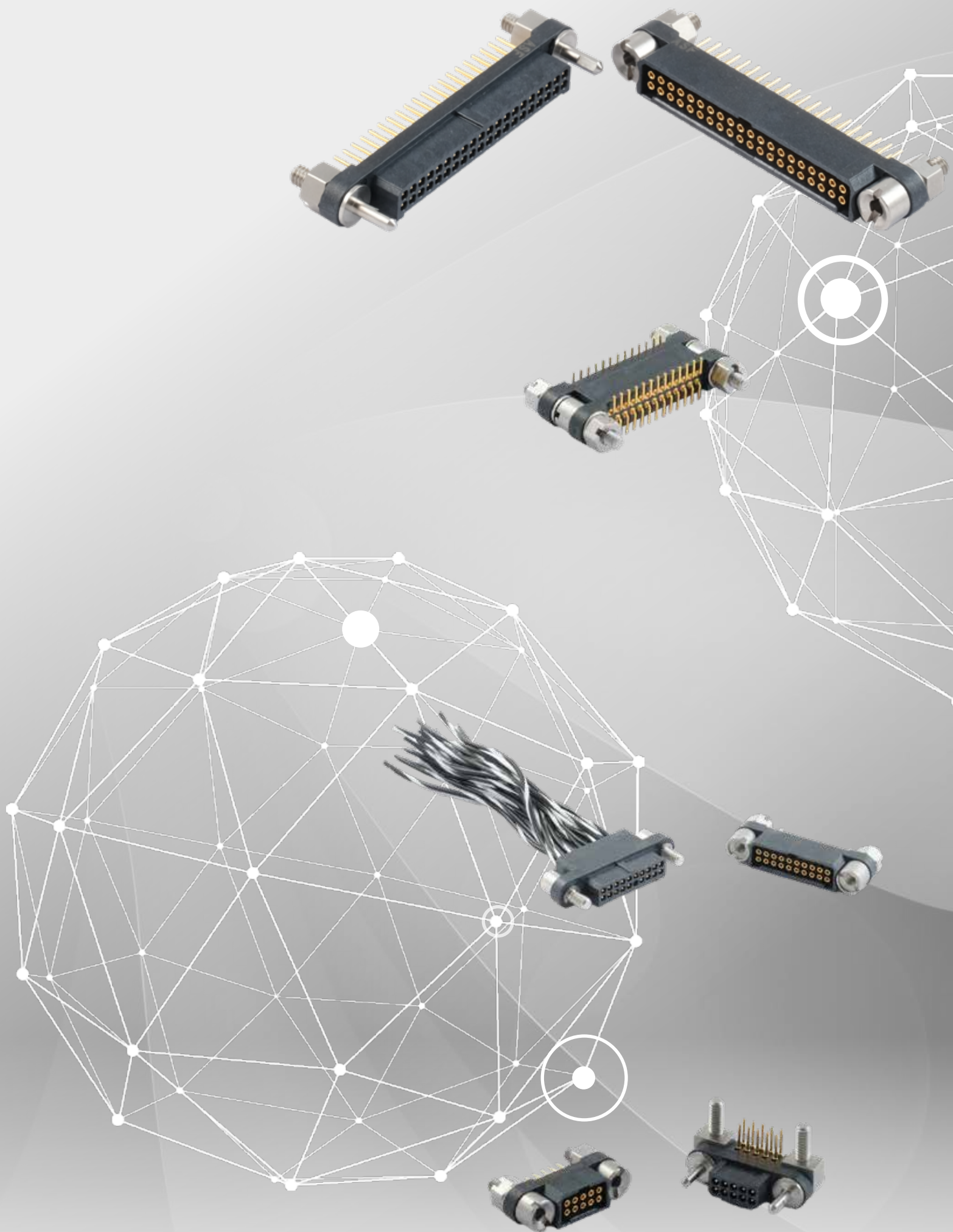



# TABLE OF CONTENTS

About Amphenol Socapex	4
Markets & applications	8
<b>MICRO HDAS - High performance &amp; versatile</b>	<b>10</b>
General characteristics	10
Overall dimensions	12
Fittings	14
PCB layout	16
How to order	17





# OUR COMPANY



## Proven excellence in interconnect solutions

- Since **1947**, Amphenol Socapex has prescribed, designed and manufactured reliable and innovative interconnection solutions for harsh environments, specializing in standard and customized electrical and fiber optic connectors, contacts, accessories and cabling solutions.
- Located in the **Mont Blanc region** of France and Pune in India, Amphenol Socapex serve customers in over 100 countries around the world.
- Amphenol Socapex is part of the leading supplier of interconnect systems **Amphenol**.



**1400+**  
employees



**142 M€**  
Net Sales 2023  
70% Export - 30% France



Thyez, **France**  
Pune, **India**



## Our expertise has no boundaries

### Integrated Production in France & India

- 24 000 m<sup>2</sup> manufacturing capacity on 2 sites
- Design and manufacturing centers in France and India
- State-of-the-art manufacturing technology

## Our markets



**Defense**



**Commercial  
Aerospace**



**Space**



**Industry**



# TECHNOLOGIES & INNOVATION

## Engineering Laboratory



**Product testing and qualification expertise in many fields:**

- Environmental, mechanical, electrical, chemical, climatic skills
- RF and fiber optics expertise

## High-Speed Expertise



**Strong expertise in high-speed signals**

- 3D EM simulation software & EM models
- Time Domain and frequency domain

## Materials Expertise



**Focus on materials expertise and manufacturing techniques to produce faster, smaller and stronger products**

- Advanced technology research and development: polymers, metals, platings, resins ...
- Cutting edge characterizations of interconnects: Radio Frequency, partial discharges ...
- 3D CAD mechanical software, simulation & analysis

## Eco-responsibility



**Sustainable environment approach, with pro-active management of regulations (REACH / RoHS / Conflict minerals...)**

- New materials development, plating, and suitable processes
- Recycling and rational resources consumption

## Our workshops



Our workshops located in France & India provide consistent quality adapted to your volume requirements.

**Automation & Tooling :** Tools for our different activities : molding, machining, assembly

**Molding :** Solid expertise in thermoplastic elastomer and thermoset molding

**Machining :** Manufacturing of cylindrical shells and rectangular shells

**Screw Machining :** Manufacturing of electrical contacts

**Plating :** Plating with cadmium, nickel, electroless nickel, silver, black zinc nickel, gold

**Assembly :** Connector and harness assembly (electrical & optical)

## Our certifications

Product certifications : MIL-DTL38999, EN3645, EN3155, VG (VG95328, VG95319, VG96944, VG95218, VG96949)



Certified Management System



Certified Management System



Certified Management System



Certified Management System

## Our memberships

Member of CMG (Connecting Manufacturing Group) Consortium





# CUSTOMER EXPERIENCE



► We have a strong reputation for helping customers solve their toughest challenges. This approach of serving your needs is ingrained in our company - from our sales team to our product development engineers.

## A partner you can trust

Customer Proximity	Design Expertise	Quality Commitment	On Time Delivery Performance	Compliance management

## Buy our solutions

You can access our solutions through our global network of sales offices or through our distributors.

### Field Sales Team :

- 10 in France
- 15 in Europe
- 100+ in North America and rest of the world.
- 5 Business Development Managers supporting local sales force Europe, North America and the rest of the world

### Technical Advisement & Multilingual Customer Service :

20 people

### Worldwide Distribution Network :

Our range of circular connectors, contacts, fiber optic connectors, PCB connectors and accessories are available thru our extensive distribution network.

It includes qualified distributors (QPL approved) for assembling MIL-DTL-38999 & derivatives and PT/451 (VG95328) connectors.



[Check our product inventory](#)



[Product Selectors & 3D Files](#)



NEW

# OUR HISTORY

1947



- **Socapex creation** in Suresnes, France
- 1<sup>st</sup> radio connector

1956-57



- **Manufacturing unit in Cluses** (74), France
- Thomson-CSF becomes primary shareholder

Early 1960's



- 1<sup>st</sup> board level connectors: HE8
- 1<sup>st</sup> "licence Bendix" manufactured connectors
- SL Series

1973



- **New factory in Thyez** (74) France with 250 people, 13 000m<sup>2</sup>

1975



- Production of 38999 connectors

1986

**Amphenol**  
Socapex

- **Amphenol** becomes primary shareholder

1995-96



- Expanded Beam connector CTOS launch
- Headquarters transferred to Thyez

2004



- RJ Field Electronica launch, "Award"

2005



- **New factory in Pune, India**

2010's



- LuxBeam™ and HDAS launch

2014-2017



- **New workshops :**
- Cable Assembly & Contact Manufacturing workshop

2019



- **Increased manufacturing capacity** with 2<sup>nd</sup> building in Pune, India

2022



- Harness in the box solution launch

Today & tomorrow



- **New technologies :**
- Investment in automation & technical expertise



- Amphenol SOCAPEX joins the "Convention des Entreprises pour le Climat".
- Our goal: **to accelerate our transition to a more sustainable operation.**



MARKETS AND APPLICATIONS



Commercial Aerospace

Fadec/Engine control  
Landing gear  
Braking system  
Display unit - Power unit  
Actuator - Flight control system



Military Aerospace

Countermeasure  
Power unit - Radar  
Display unit - Flight control system  
POD - Braking system  
FADEC/Engine control  
UAV



Ground Vehicle



C4ISR

Countermeasure  
Threat detection system  
Rugged computer  
Digital radio  
Ground radio - Communication systems



Missile

Missile launcher  
POD  
Missile



Space

Space vehicles  
Satellites  
Launchers





# MICRO HDAS

**Amphenol** SOCAPEX



# GENERAL CHARACTERISTICS - MICRO HDAS



High performance and high density miniature connector

## Description

Amphenol Socapex introduce the Micro HDAS, its new micro board to board and board to wire connector. Micro HDAS allows you to save space on your board while maintaining a high level of performances. Offering you PC Tail, SMT & crimp contact terminations, Micro HDAS provides a modularity to fit all your needs.

## Benefits

- Space & weight reduction to meet your miniaturization needs
- High density : 1.27mm [.050"] pitch
- Protected contacts by design
- 7,4mm distance between boards

## Features

- 29 arrangements, from 4 to 60 contacts
- PC Tail, SMT & Crimp contacts
- Meet & Exceed MIL-DTL-55302G & 83513G
- Full range of fittings to answers your needs

## Configurations

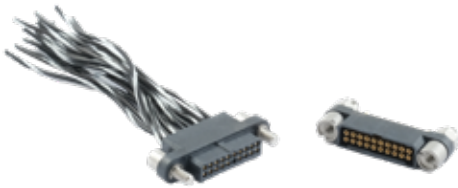

Board to wire  
(Crimp AWG 24 to 30)



Mezzanine



Mother board to  
Daughter board

## Exploded views and Materials

### CONTACTS



Male pins: copper alloy, 0.75µm gold

Female pins (inner): beryllium copper, 1.27µm gold  
Female pins (outer): copper alloy, 0.125µm gold

### INSULATORS

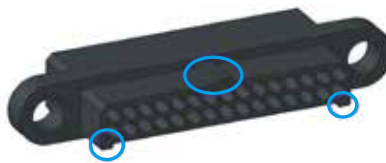

30% glass-filled thermoplastic (LCP)  
UL94V-0  
Polarized

### FITTINGS



Passivated Stainless Steel

## Online configurator & 3D model download



Scan me



# GENERAL CHARACTERISTICS - MICRO HDAS SERIES



## Technical Specifications

MECHANICAL CHARACTERISTICS	MICRO HDAS	MIL-DTL-55302	
Backoff - Electrical security (mm)	1,27	N/A	
Contact engagement & separation forces			
Mating force per contact (N)	0,39 < F < 0,68	4.5.3	
Unmating force per contact (N)	0,16 < F < 0,21		
Mating and unmating forces - Initial - Tested on a 30 ways connector			
Mating forces (N) - average per contact	0,44	4.5.4	
Unmating forces (N) - average per contact	0,31		
Durability cycles	500	4.5.9	
Sinusoidal vibrations	Up to 45g	4.5.10	
Shocks (sawtooth/6ms)	Up to 160g	4.5.10	
Fixing torque between connector and PCB (N.m)	0,3	N/A	
Fixing torque between connectors (N.m)	0,2	N/A	
Crimp tensile strength	AWG 24 > 49,98N	N/A	
	AWG 26 > 36,64N		
	AWG 28 > 19,90N		
	AWG 30 > 11,30N		
ENVIRONMENTAL CARACTERISTICS			
Operating Temperature (°C)	-65/+150	4.5.13	
Salt spray (hours)	96	4.5.11	
Humidity - 25/65°C - 90-95%	10 cycles of 24 hours	4.5.15	
Thermal vacuum outgassing Applicable to LCP housing, PEEK ring (AWG 24 contact) and backpotting Stycast 2651 MM + Catalyst 9	Total mass loss : TML < 1% of the original mass Max volatile condensable material : CVCM < 0.1% of the original mass	ASTM E595 (ECSS-Q-ST-70 02C)	
ELECTRICAL CARACTERISTICS			
Current rating per contact (A) - 30 ways connector	Contact configuration	@25°C	@85°C
	YD/YD YD/YC	3,4A 3,9A	2,5A 2,6A
	YD/CRIMP	Depending on cable, up to 5A	
Insulation resistance (at 500Vdc) (GΩ)	> 5	4.5.8	
Contact resistance (mΩ)	< 8	4.5.5	
Dielectric withstanding voltage (Vrms) at sea level	750	4.5.7.1	
Dielectric withstanding voltage (Vrms) 70 000 feet (between contacts)	480		

## Connector marking

Micro HDAS connectors are laser marked.

Exemple of marking :

Series name	Contact type	Date code
MHDAS	YC	YYWW

Series name : MHDAS = Micro HDAS

Contact type : as specified in our how to order

YYWW : year + week batch



# OVERALL DIMENSIONS - MICRO HDAS

## Male for cable

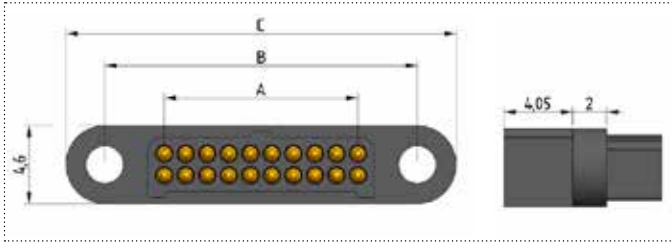

## Female for cable

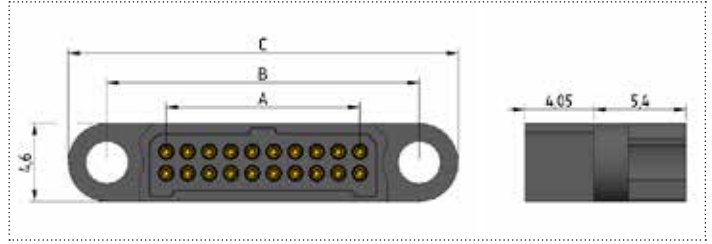

## Male Straight Thru Hole

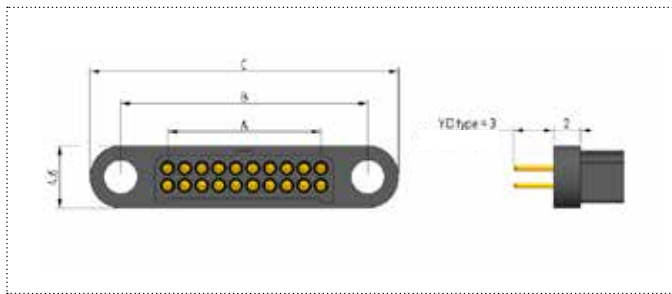

## Female Straight Thru Hole

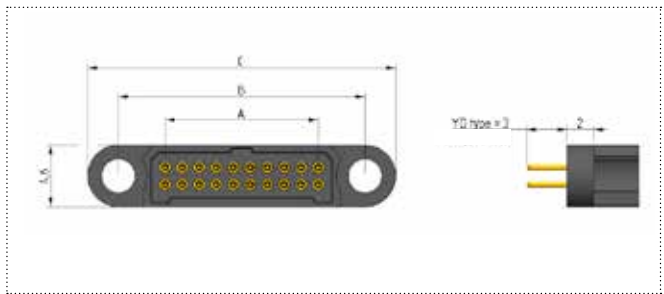

## Male 90° Thru Hole

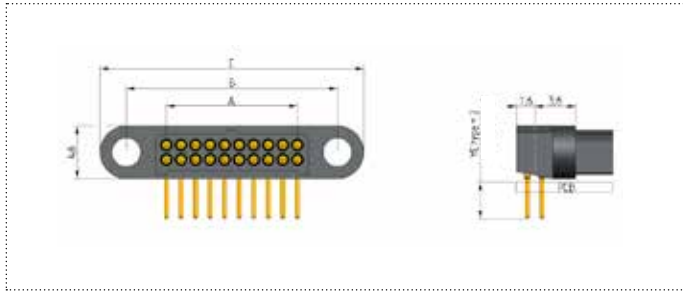

## Female 90° Thru Hole

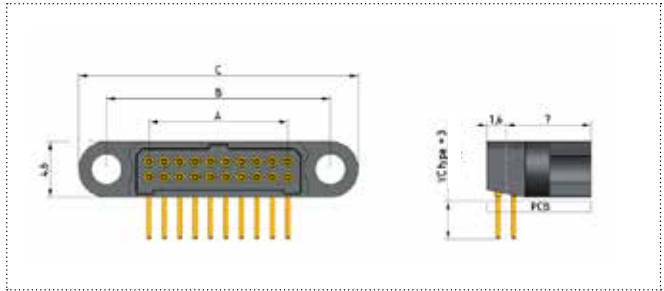

Dimension table

LF contact number	4	6	8	10	12	14	16	18	20	22	24	26	28	30	32	34	36	38	40	42	44	46	48	50	52	54	56	58	60
A = Distance between pins (mm)	1.27	2.54	3.81	5.08	6.35	7.62	8.89	10.16	11.43	12.70	13.97	15.24	16.51	17.78	19.05	20.32	21.59	22.86	24.13	25.40	26.67	27.94	29.21	30.48	31.75	33.02	34.29	35.56	36.83
B = Distance between fittings (mm)	8.27	9.54	10.81	12.08	13.35	14.62	15.89	17.16	18.43	19.70	20.97	22.24	23.51	24.78	26.05	27.32	28.59	29.86	31.13	32.4	33.67	34.94	36.21	37.48	38.75	40.02	41.29	42.56	43.83
C = Distance between extremities (mm)	12.87	14.14	15.41	16.68	17.95	19.22	20.49	21.76	23.03	24.3	25.57	26.84	28.11	29.38	30.65	31.92	33.19	34.46	35.73	37	38.27	39.54	40.81	42.02	43.35	44.62	45.89	47.16	48.43

# OVERALL DIMENSIONS - MICRO HDAS

## Male Straight SMT

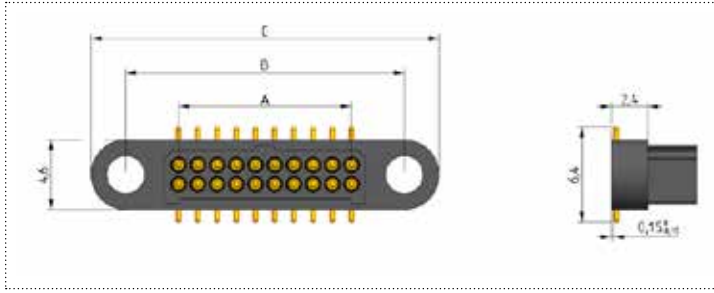

## Female Straight SMT

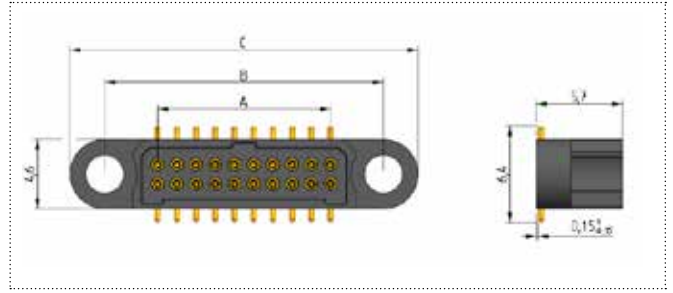

## Male 90° SMT

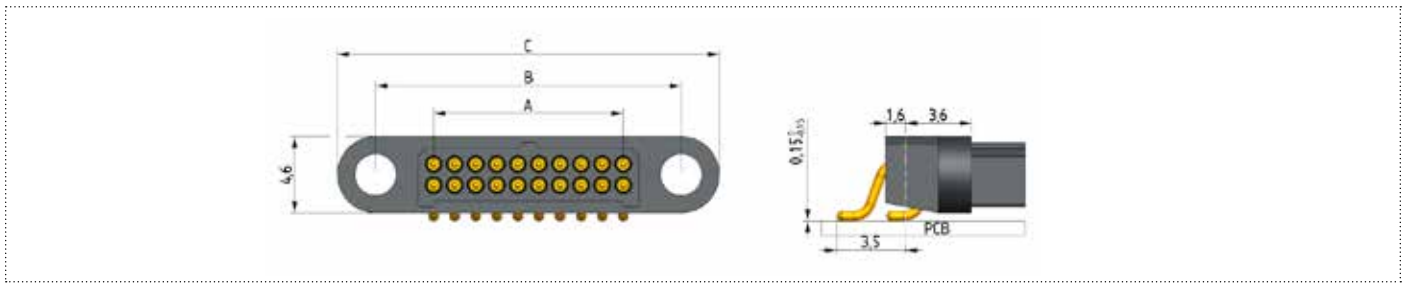

Dimension table

LF contact number	4	6	8	10	12	14	16	18	20	22	24	26	28	30	32	34	36	38	40	42	44	46	48	50	52	54	56	58	60
A = Distance between pins (mm)	1.27	2.54	3.81	5.08	6.35	7.62	8.89	10.16	11.43	12.70	13.97	15.24	16.51	17.78	19.05	20.32	21.59	22.86	24.13	25.40	26.67	27.94	29.21	30.48	31.75	33.02	34.29	35.56	36.83
B = Distance between fittings (mm)	8.27	9.54	10.81	12.08	13.35	14.62	15.89	17.16	18.43	19.70	20.97	22.24	23.51	24.78	26.05	27.32	28.59	29.86	31.13	32.4	33.67	34.94	36.21	37.48	38.75	40.02	41.29	42.56	43.83
C = Distance between extremities (mm)	12.87	14.14	15.41	16.68	17.95	19.22	20.49	21.76	23.03	24.3	25.57	26.84	28.11	29.38	30.65	31.92	33.19	34.46	35.73	37	38.27	39.54	40.81	42.02	43.35	44.62	45.89	47.16	48.43

# FITTINGS - MICRO HDAS

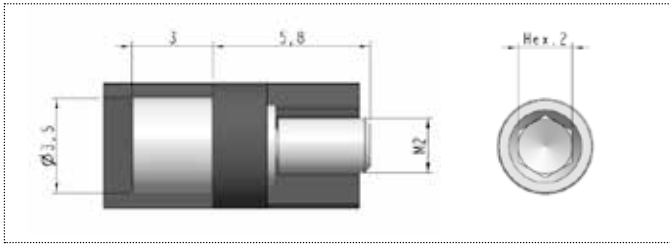
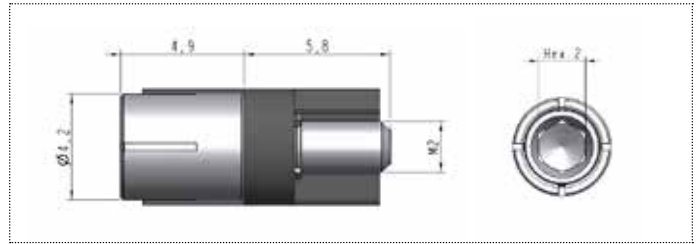
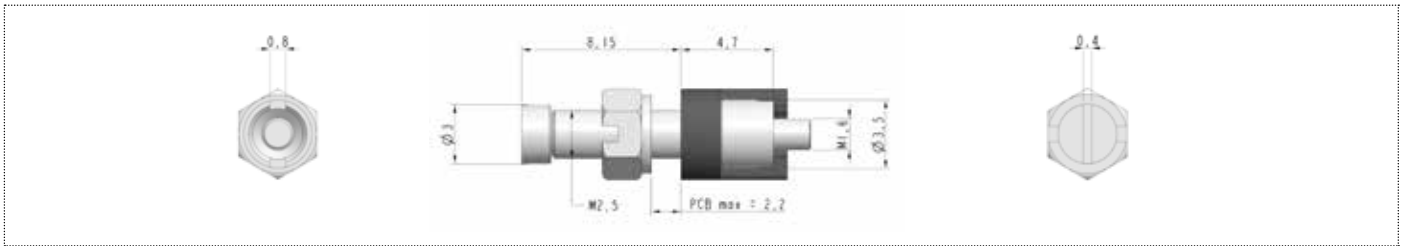
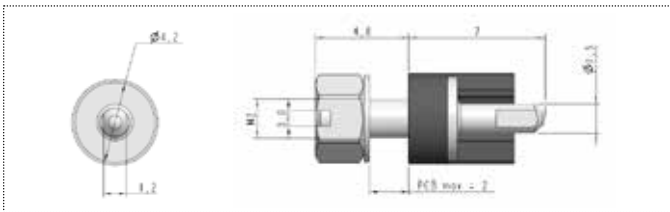
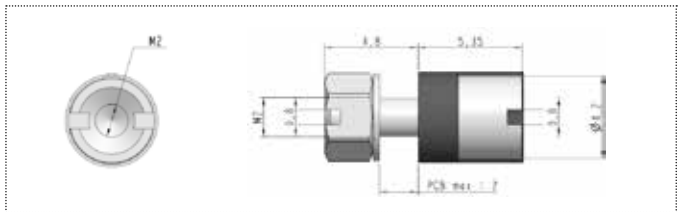
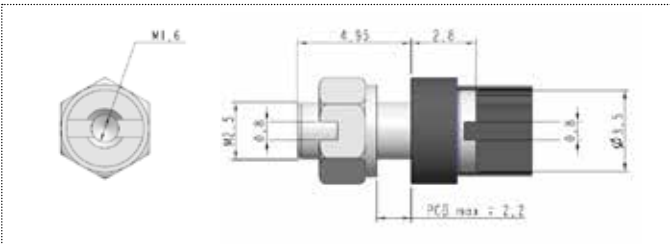
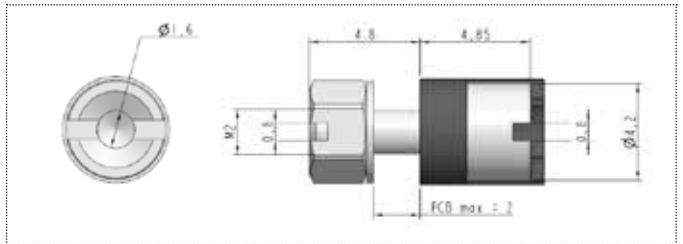
**E01**

**E02**

**E03**

**E10**

**E50**

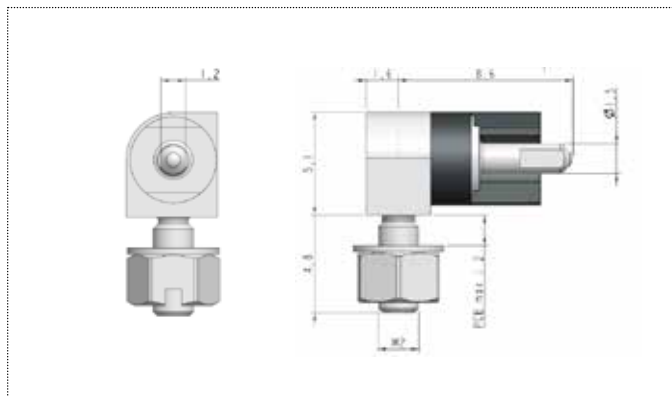
**E53**

**E60**

## Fittings compatibility

Signal Contact	Fitting	Torque (N.m)		Compatible with
A - B - G - YD - T	<b>E01</b>	0.3		E50 or E51
	<b>E02</b>	0.3		E50 or E51
	<b>E03</b>	On PCB: 0.25	On coupled part: 0.16	E53 or E63
	<b>E10</b>	0.3		E60 or E61
	<b>E50</b>	0.3		E01 or E02
	<b>E53</b>	0.3		E03
YC - R	<b>E60</b>	0.3		E10 or E11
	<b>E11</b>	0.3		E60 or E61
	<b>E51</b>	0.3		E01 or E02
	<b>E61</b>	0.3		E10 or E11
	<b>E63</b>	0.3		E03



## E11



## E51

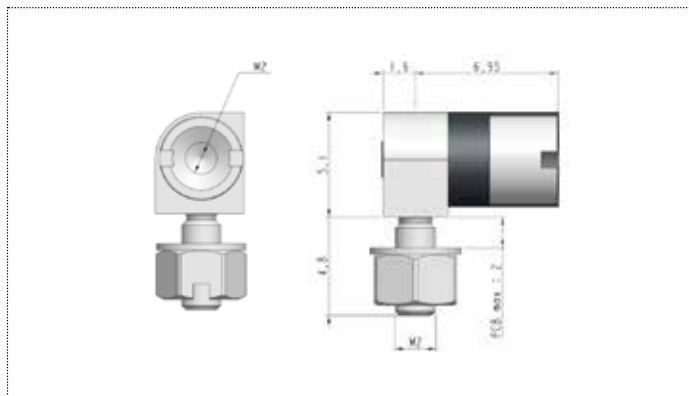

## E61

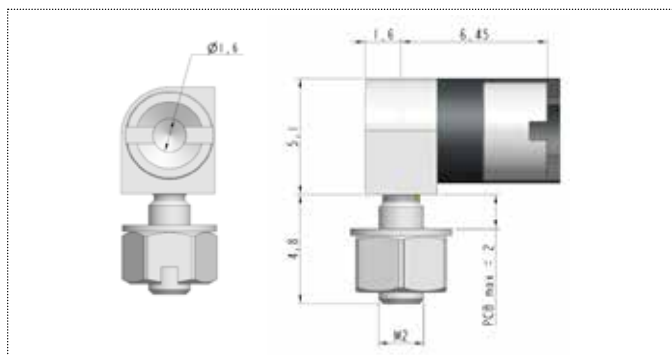

## E63

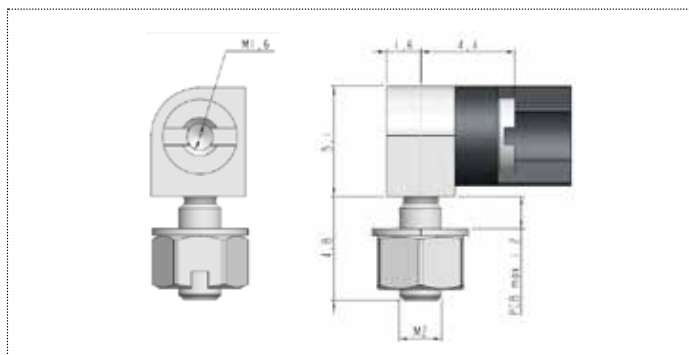

## Nut + washer

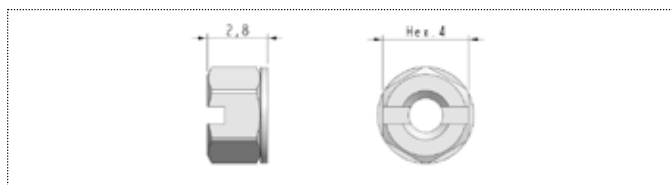

## Fittings compatibility

Signal Contact	Fitting		Torque (N.m)		Compatible with
A - B - G - YD - T	E01	Jackscrew for harness	0.3		E50 or E51
	E02	Captive Screw for harness	0.3		E50 or E51
	E03	Jackscrew for PCB/Panel mount	On PCB: 0.25	On coupled part: 0.16	E53 or E63
	E10	Male straight guiding	0.3		E60 or E61
	E50	Female straight jackscrew	0.3		E01 or E02
	E53	Female straight jackscrew	0.3		E03
	E60	Female straight guiding	0.3		E10 or E11
YC - R	E11	Male 90° guiding	0.3		E60 or E61
	E51	Female 90° jackscrew	0.3		E01 or E02
	E61	Female 90° guiding	0.3		E10 or E11
	E63	Female 90° jackscrew	0.3		E03

## PCB LAYOUT - MICRO HDAS

### Straight/90° on PCB

#### THROUGH-HOLE PCB LAYOUT

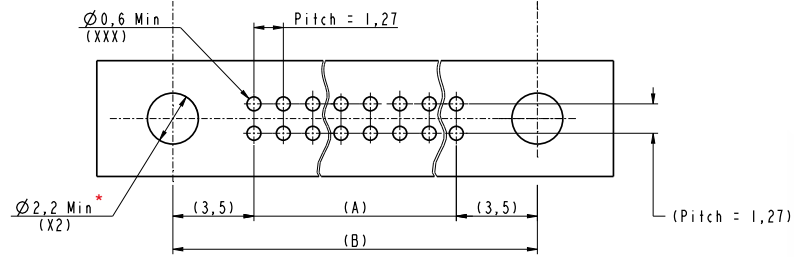

\* Ø 2.8 Min with E03 and E53 fittings

### Straight on PCB

#### SMT TYPE PCB LAYOUT

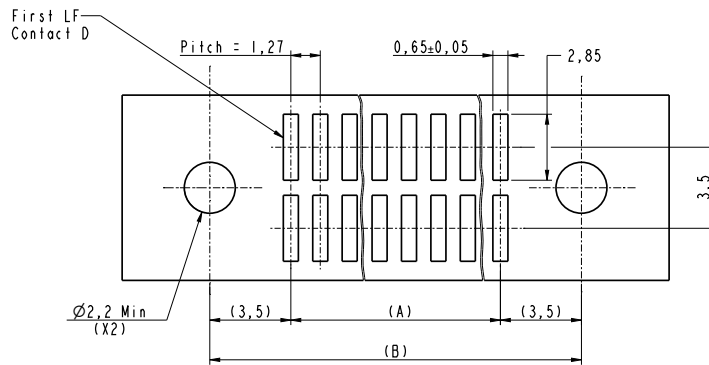

### 90° on PCB

#### SMT TYPE PCB LAYOUT

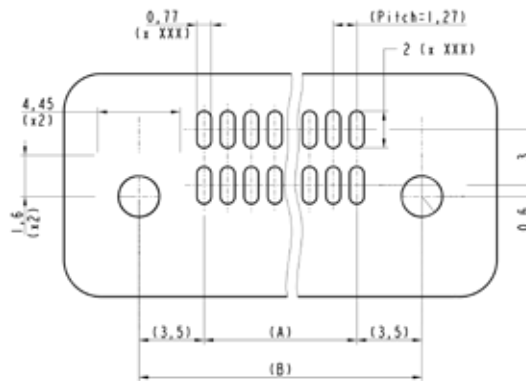

Dimension table

LF contact number	4	6	8	10	12	14	16	18	20	22	24	26	28	30	32	34	36	38	40	42	44	46	48	50	52	54	56	58	60
A = Distance between pins (mm)	1.27	2.54	3.81	5.08	6.35	7.62	8.89	10.16	11.43	12.70	13.97	15.24	16.51	17.78	19.05	20.32	21.59	22.86	24.13	25.40	26.67	27.94	29.21	30.48	31.75	33.02	34.29	35.56	36.83
B = Distance between fittings (mm)	8.27	9.54	10.81	12.08	13.35	14.62	15.89	17.16	18.43	19.70	20.97	22.24	23.51	24.78	26.05	27.32	28.59	29.86	31.13	32.4	33.67	34.94	36.21	37.48	38.75	40.02	41.29	42.56	43.83

## HOW TO ORDER - MICRO HDAS



Straight on PCB

90° on PCB

For Harnesses

1.

2.

3.

4.

5.

6.

Series	Number of rows	Connector type	Number of contacts	Contact type	Fitting type
MHDAS	2	M	016	YD	E10

## 1. Series

MHDAS Micro HDAS 1.27mm pitch

## 5. Contact type

YD Straight PC tail standard ✓  
T Straight SMT ✓



## 2. Number of rows

2 2 rows connector

## 6. Fitting type

E10 Male straight guiding  
E50 Female straight jackscrew  
E60 Female straight guiding  
E01 Jackscrew for harness  
E02 Captive screw for harness  
E03 Jackscrew for PCB/Panel mount  
E53 Female straight jackscrew

## 3. Connector type

M Male connector  
F Female connector

## 4. Number of contacts

004	024	044
006	026	046
008	028	048
010	030	050
012	032	052
014	034	054
016	036	056
018	038	058
020	040	060
022	042	

All the fittings type are compatible with male and female contacts.



# HOW TO ORDER - MICRO HDAS

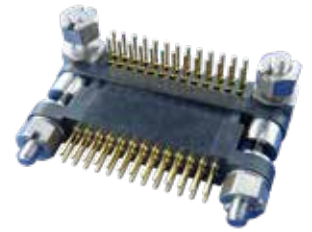

Straight on PCB

**90° on PCB**

For Harnesses

1.	2.	3.	4.	5.	6.
Series	Number of rows	Connector type	Number of contacts	Contact type	Fitting type
<b>MHDAS</b>	<b>2</b>	<b>M</b>	<b>016</b>	<b>YC</b>	<b>E11</b>

## 1. Series

**MHDAS** Micro HDAS 1.27mm pitch

## 2. Number of rows

**2** 2 rows connector

## 3. Connector type

**M** Male connector

**F** Female connector

## 4. Number of contacts

<b>004</b>	<b>024</b>	<b>044</b>
<b>006</b>	<b>026</b>	<b>046</b>
<b>008</b>	<b>028</b>	<b>048</b>
<b>010</b>	<b>030</b>	<b>050</b>
<b>012</b>	<b>032</b>	<b>052</b>
<b>014</b>	<b>034</b>	<b>054</b>
<b>016</b>	<b>036</b>	<b>056</b>
<b>018</b>	<b>038</b>	<b>058</b>
<b>020</b>	<b>040</b>	<b>060</b>
<b>022</b>	<b>042</b>	

## 5. Contact type



**YC** Right angle PC tail standard ✓

**R** Right angle SMT (only male) ✓

## 6. Fitting type

**E11** Male 90° guiding

**E51** Female 90° jackscrew

**E61** Female 90° guiding

**E63** Female 90° jackscrew

*All the fittings type are compatible with male and female contacts.*

## HOW TO ORDER - MICRO HDAS

Straight on PCB

90° on PCB

For Harnesses



1.	2.	3.	4.	5.	6.
Series	Number of rows	Connector type	Number of contacts	Contact type	Fitting type
MHDAS	2	M	016	A	E02

## 1. Series

MHDAS Micro HDAS 1.27mm pitch

## 2. Number of rows

2 2 rows connector

## 3. Connector type

M Male connector

F Female connector

## 4. Number of contacts

004	024	044
006	026	046
008	028	048
010	030	050
012	032	052
014	034	054
016	036	056
018	038	058
020	040	060
022	042	

For harnesses, backpotting is recommended for enhanced protection.

## 5. Contact type



A Crimp AWG 24 ✓

B Crimp AWG 26 ✓

G Crimp AWG 28-30 ✓

Contacts A and B are the same ones. The differentiation comes from the addition of a ring in peek to crimp the AWG 24.

## 6. Fitting type

E01 Jackscrew for harness

E02 Captive screw for harness

E10 Male straight guiding

E50 Female straight jackscrew

E60 Female straight guiding

E03 Jackscrew for PCB/Panel mount

E53 Female straight jackscrew

All the fittings type are compatible with male and female contacts.

## Order contacts:

Code	Reference		Type	Cable gauge
	Male	Female		
A	MHDASMAB	MHDASFAB	To be crimped	AWG 24
	MHDASARING			
B	MHDASMAB	MHDASFAB		AWG 26
G	MHDASMG	MHDASFG	AWG 28-30	

Feel free to contact us if you require a full wired solution.

# TOOLING & INSTRUCTION - MICRO HDAS

## Signal contact crimping tool

Reference	Description
MH800	Hand crimp tool DANIELS
K2024	Positioner for Micro HDAS signal contacts

Access our crimping instruction for Micro HDAS connector signal contacts : PCB-ER-020-Ext.



Scan me



TECHNICAL NOTE

MHDAS : CRIMPING INSTRUCTIONS

## Signal contact insertion and extraction tool

Reference	Description
MHDASODIEC	Insertion and extraction tool for Micro HDAS signal contacts

Access our insertion and extraction instruction for Micro HDAS connector signal contacts : PCB-ER-016-Ext.



Scan me



TECHNICAL NOTE

MHDAS : CRIMP CONTACT  
INSERTION/EXTRACTION  
INSTRUCTION

## Backpotting

Amphenol Socapex recomend to do backpotting with Stycast 2651MM and Catalyst 9 (10%).





# NOTES

Area for handwritten notes, consisting of multiple horizontal dotted lines.

## NOTES

Area for handwritten notes, consisting of multiple horizontal dotted lines.

# ABOUT AMPHENOL

Founded in 1932, **Amphenol** is one of the largest manufacturers of interconnect products in the world. The company designs, manufactures, and markets electrical, electronic, and fiber optic connectors, interconnect systems, and coaxial and specialty cables.

**Amphenol** has a diversified presence as a leader in high growth areas of the interconnect industry and provides solutions for customers in the automotive, broadband, industrial, information technology and data communications, military and aerospace, mobile devices, and mobile networks markets.

More info on [www.amphenol.com](http://www.amphenol.com)

**Amphenol**  
ENABLING THE ELECTRONICS REVOLUTION

## Europe

FRANCE	Amphenol AIR LB	2 rue Clément Ader, ZAC de Wé - 08110 Carignan	+33 3 24 22 78 49
FRANCE	Amphenol SEFEE	Z.I. des Cazes – BP243 - 12402 Saint-Affrique Cedex	+33 5 65 98 11 00
GERMANY	Amphenol AIR LB GMBH	Am Kleinbahnhof 4 - 66740 Saarlouis	+49 6831 981 00
ITALY	Amphenol EUROPEAN SALES OPERATIONS	Via Barbaiana n.5 - 20020 Lainate - Milano	+39 293 254 214
UNITED KINGDOM	Amphenol INVOTEC	Unit 1-3, Hedging Lane Industrial Estate, Dosthill - Tamworth, B77 5HH	+44 1827 263 000
UNITED KINGDOM	Amphenol IONIX SYSTEMS	Prospect House, Taylor Business Park, Risley, Warrington, WA3 6HP	+44 1 942 685 200
UNITED KINGDOM	Amphenol LTD	Thanet Way, Whitstable - KENT, CT53JF	+44 1227 773 200
UNITED KINGDOM	Amphenol MARTEC	St Augustines Business Park, Swalecliffe Whitstable - Kent CT5 2QJ	+44 1227 793 733

## North America

CANADA	Amphenol CANADA	605 Milner avenue - Toronto, Ontario	+1 416 291 0647
USA	Amphenol AEROSPACE OPERATIONS	40-60 Delaware street - Sidney, NY 13838	+1 800 678 0141
USA	Amphenol BORISH TECHNOLOGIES	4511 East Paris AVE - Grand Rapids, MI 49512	+1 616 554 9820
USA	Amphenol FSI	1300 Central Expwy N, Suite 100 - Allen, TX 75013	+1 214 547 2400
USA	Amphenol GRIFFITH ENTERPRISES	6000 East Coury Drive - Cottonwood, AZ 86326	+1 928 634 3685
USA	Amphenol NEXUS TECHNOLOGIES	50 Sunnyside Avenue - Stamford, CT 06902	+1 203 327 7300
USA	Amphenol PCD	72 Cherry Hill Drive - Beverly, MA. 01915	+1 978 624 3400
USA	Amphenol PRINTED CIRCUIT	Board Technology, 91 Northeastern Boulevard - Nashua, NH 03062	+1 603 324 4500
USA	Amphenol SV MICROWAVE	2400 Centrepark West Drive - West Palm Beach, FL	+1 561 840 1800
USA	Amphenol TIMES MICROWAVE	358 Hall Avenue - Wallingford, CT 06492	+1 800 867 2629

## Asia

CHINA	Amphenol PCD CO.	Building 21, 1 <sup>st</sup> Liao Keng Industrial Zone, Shi Yan Street - Bao An District - Shenzhen 518108	+86 755 8173 8000/8286
INDIA	Amphenol INTERCONNECT INDIA	105 Bhosari Industrial Area - Pune 411 026	+91 20 27120363
JAPAN	Amphenol JAPAN	471-1, Deba, Ritto-City - Shiga 520 3041	+81 77 553 8501
KOREA	Amphenol DAESHIN	558 SongNae-Dong SoSa-Gu, Bucheon-city, Kyunggi-Do - 420-130	+81 32 610 3830/3845
SINGAPORE	Amphenol EAST ASIA	26/F, Railway Plaza, 39 Chatham Road South, Tsim Sha Tsui, Kowloon, Hong Kong	+65 6294 2128

## Other Areas

AFRICA	Amphenol AFRICA	30 Impala Rd - Sandton 2146	+27 82 410 5179
ARGENTINA	Amphenol ARGENTINA	Av. Callao 930 2do piso Oficina B "Plaza" C1023 - AAP Buenos Aires	+54 11 4815 6886
AUSTRALIA	Amphenol AUSTRALIA PTY	2 Fiveways Blvd., Keysborough - Melbourne - Victoria 3173	+61 3 8796 8888
BRAZIL	Amphenol DO BRAZIL	Rua Diogo Moreira, 132, 20 andar, rooms 2001-2-3	+55 11 3815 1003
ISRAEL	Amphenol BAR-TEC	3 Hagavish Street, K fir-Barkan Bldg. East Industrial Zone - Kfar-Sava, 44102	+972 9 764 4100
MEXICO	Amphenol OPTIMIZE	Carretera Internacional Km 6.5, Col. Parque Industrial, Nogales, Sonora, C.P. 84094	+52 631 311 160
NEW ZEALAND	Amphenol PHITEK	Level 4, 2 Kingdon Street, Newmarket, Auckland 1023	+64 9 524 2984
TURKEY	Amphenol TURKEY	Sun Plaza 15 Kat: 15 Maslak Hah. Bilim Sok. No.5 - Sisli/Istanbul, 34398	+90 212 367 92 19

# Amphenol SOCAPEX



## Amphenol Socapex

948, promenade de l'Arve BP29  
74311 Thyez Cedex - France

+33 (0)4 50 89 28 00

[contact@amphenol-socapex.fr](mailto:contact@amphenol-socapex.fr)

[www.amphenol-socapex.com](http://www.amphenol-socapex.com)



## For Technical Support

+33 (0)4 50 89 28 49

[technicalsupport@amphenol-socapex.fr](mailto:technicalsupport@amphenol-socapex.fr)



## To buy our products

+33 (0)4 50 90 28 00

[contact@amphenol-socapex.fr](mailto:contact@amphenol-socapex.fr)

[www.amphenol-socapex.com/amphenol/sales](http://www.amphenol-socapex.com/amphenol/sales)

Request a quote online at [www.amphenol-socapex.com/quotation\\_request](http://www.amphenol-socapex.com/quotation_request)



## Documentation

[www.amphenol-socapex.com/documentation](http://www.amphenol-socapex.com/documentation)

To order a paper version of our catalogs, send an e-mail to [communication@amphenol-socapex.fr](mailto:communication@amphenol-socapex.fr)

Check our product  
inventory



Product Selectors  
& 3D Files



NEW



[www.amphenol-socapex.com](http://www.amphenol-socapex.com)

Follow Amphenol Socapex on social media :



This catalog uses paper from managed forests, PEFC & FSC labels, and is printed by a printer certified "Imprim'Vert®"

We reserve the right to modify our products in any way we deem necessary.

Any duplication is prohibited, unless approved in writing.

DOC-001069-ANG - January 2025

Designed by Amphenol Socapex